

Cometa   

Scaldasalviette in ottone costituito da elementi di diametro 30 mm e sfere di collegamento.

Towel warmer in brass made of elements with 30 mm diameter and connection spheres.

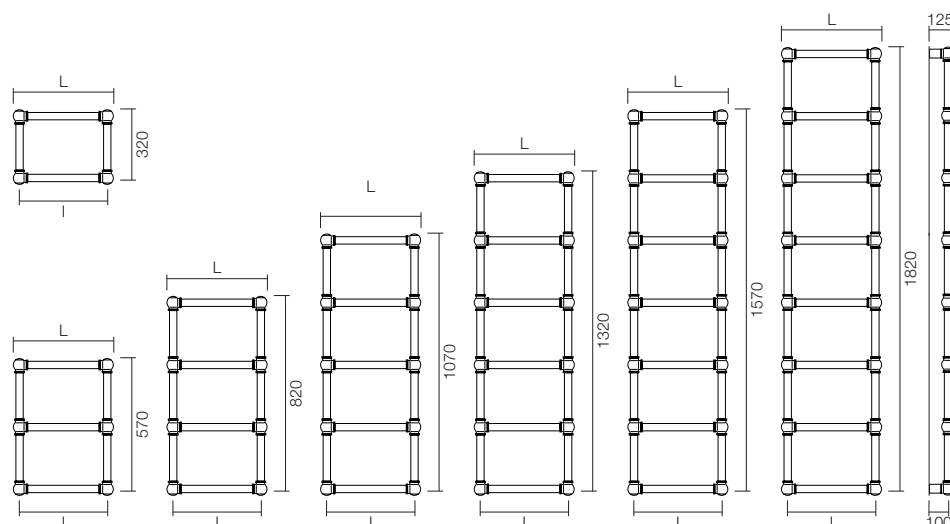

Kit fissaggio a parete e valvola sfiato inclusi.  
Brackets for wall fixing and exhaust valve included.

Codice Code	Altezza H Height H	Larghezza L Width L	Interasse I Pipe centre I	Elementi Elements	Resa/Output $\Delta t$ 50°		Cromo Chrome	Oro Gold	Argento sat. Satin silver	Bronzo Bronze	Rame Copper
					Watt	Kcal/h					
C03040	320	420	350	2	81,0	70,0					
C03050	320	520	450	2	103,0	89,0					
C03060	320	620	550	2	121,0	104,0					
C06040	570	420	350	3	122,0	105,0					
C06050	570	520	450	3	152,0	131,0					
C06060	570	620	550	3	178,0	153,0					
C08040	820	420	350	4	160,0	138,0					
C08050	820	520	450	4	198,0	170,0					
C08060	820	620	550	4	237,0	204,0					
C011040	1070	420	350	5	200,0	172,0					
C011050	1070	520	450	5	251,0	216,0					
C011060	1070	620	550	5	295,0	254,0					
C013040	1320	420	350	6	238,0	205,0					
C013050	1320	520	450	6	301,0	259,0					
C013060	1320	620	550	6	352,0	303,0					
C016040	1570	420	350	7	279,0	240,0					
C016050	1570	520	450	7	347,0	298,0					
C016060	1570	620	550	7	410,0	353,0					
C018040	1820	420	350	8	323,0	278,0					
C018050	1820	520	450	8	398,0	342,0					
C018060	1820	620	550	8	470,0	404,0					

COLORI / COLOURS (p. 114)

Classici / Classic: non disponibili / not available  
Raggrinzati / Wrinkled: non disponibili / not available  
Metallizzati / Metallic: non disponibili / not available

Per altre dimensioni non indicate, chiedere fattibilità e quotazione.  
For other dimensions no indicated, ask for feasibility and quotation.

FUNZIONAMENTO MISTO / MIXED VERSION (p. 71)

VALVOLAME / VALVES (p. 110)

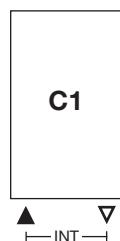

ALLACCIAMENTI STANDARD  
STANDARD CONNECTIONS

ALTRI ALLACCIAMENTI (p. 108)  
OTHER CONNECTIONS (p. 108)

# FUNZIONAMENTO MISTO MIXED VERSION

## POTENZA RESISTENZA ELETTRICA

La potenza della resistenza elettrica (Watt) non deve superare quella prodotta dal radiatore a funzionamento idraulico, indicata nelle tabelle tecniche.

## DIMENSIONI RADIATORI

Per garantire il corretto funzionamento del radiatore si consiglia la larghezza massima di 1000 mm; per larghezze superiori contattare il nostro Ufficio Tecnico.

## POWER ELECTRICAL RESISTANCE

The power of the electrical resistance (Watt) must not exceed that produced by the radiator in hydraulic version, indicated in the technical tables.

## DIMENSIONS RADIATORS

To ensure correct operation of the radiator, a maximum width of 1000 mm is recommended; for greater widths contact our Technical Department.



**Kit RE**

Codice Code	Finitura Finish
MREB	Bianco/White
MREC	Cromo/Chrome



**Kit IN**

Codice Code	Finitura Finish
MINB	Bianco/White
MINC	Cromo/Chrome



**Kit TA**

Codice Code	Finitura Finish
MTAB	Bianco/White
MTAC	Cromo/Chrome



**Kit CD**

Codice Code	Finitura Finish
MCDB	Bianco/White
MCDC	Cromo/Chrome



**Copricavo**  
(altezza 50 mm).  
**Cable cover**  
(height 50 mm).

Codice Code	Bianco White	Cromo Chrome	Colorato Coloured
COC			



**Telecomando**  
Permette di gestire il funzionamento del kit CD (dimensioni 109x52x22 mm).  
**Remote control**  
It permits to control the working of kit CD (dimensions 109x52x22 mm).



**TUBE0651 / TUBE0652**  
Valvola e detettore per funzionamento misto.  
Valve and holder for mixed version.

VALVOLAME / VALVES (p. 110)

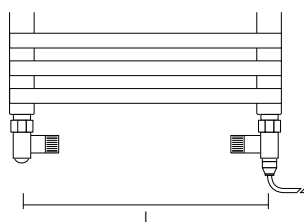

Interasse invariato.  
Unchanged pipe centre.



**Raccordo a T  
T connection**

Codice Code	Finitura Finish
RATB	Bianco/White
RATC	Cromo/Chrome

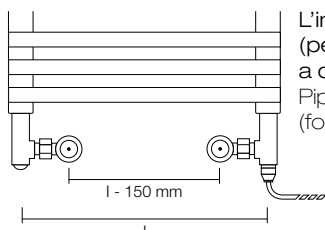
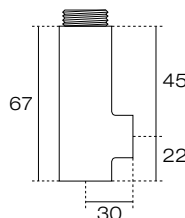

L'interasse si riduce di 150 mm.  
(per valvole e detettori a catalogo)  
Pipe centre is reduced by 150 mm.  
(for valves and holders in catalogue)

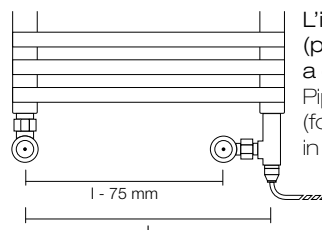

L'interasse si riduce di 75 mm.  
(per valvole e detettori a catalogo)  
Pipe centre is reduced by 75 mm.  
(for valves and holders in catalogue)